

Frame Elevation 1:10

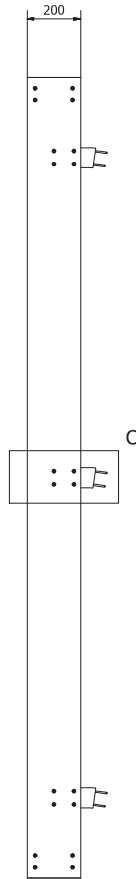

Detail C 1:2
Folded Bracket Detail

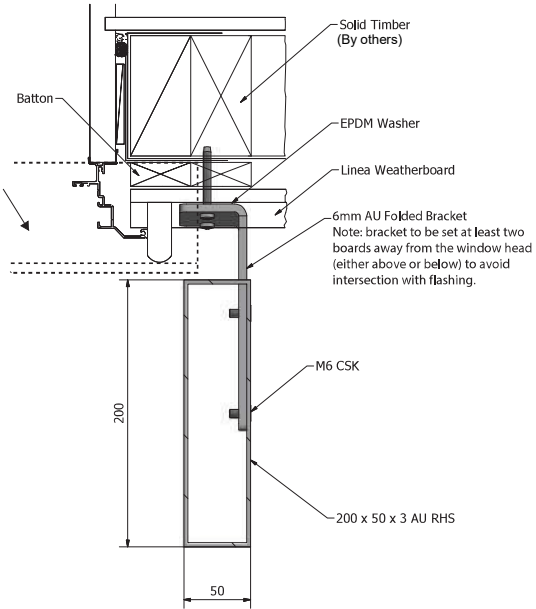

Detail A 1:2
Jamb Fixing Detail

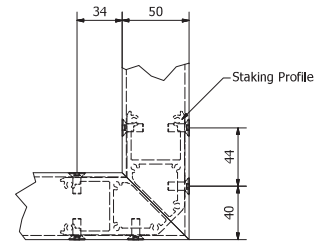

Detail B 1:2
Frame Corner Staking Detail

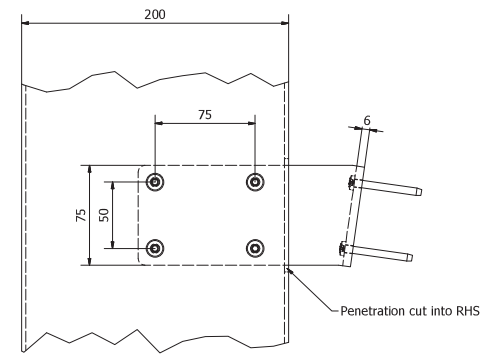

Detail C 1:2
Folded Bracket Detail

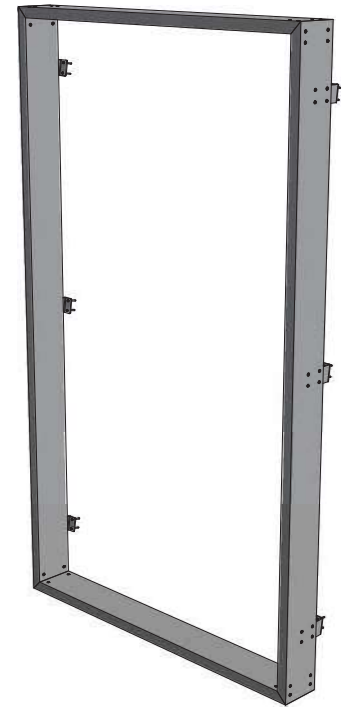

CHECKED AND APPROVED
22/02/17 BY MATT BISHOP
CPENG NO. 243276
BVT CONSULTING LTD

Revision Table			
Rev	Description	By	Date

Tolerance:
Dimension Decimal Places:
0 = +/- 1mm
0.0 = +/- 0.1mm
Angle = +/- 1°

*Unless otherwise stated. Do not scale. If in doubt ask.

File:
C:\Users\INSOL\Dropbox (Insol Ltd)\Insol\Product Information\Standard Details\Vendor Models\Window Hood Rear Mount Fixing Detail.dwg

Third Angle



All dimensions are in mm unless otherwise stated

Material: N/A
Weight:
Finish:
Qty Req as Shown:
Qty Req Opp Hand:



INSOL Architectural Aluminium Louvres
P O Box 231, Invercargill
Free 0800 34 6000
Ph 216 3287
Fax 03 216 5928
www.insolnz.co.nz

Title: Window Hood Standard Fixing Detail		Drawing No: IN-1 -STDWH-1.1	Rev: A
Desc: Weatherboard Bracket		Org Date: 1/12/2016	
		Dwg By: DM	App By: DM
		Scale: 1:10	
		Project No: STDWH	A1

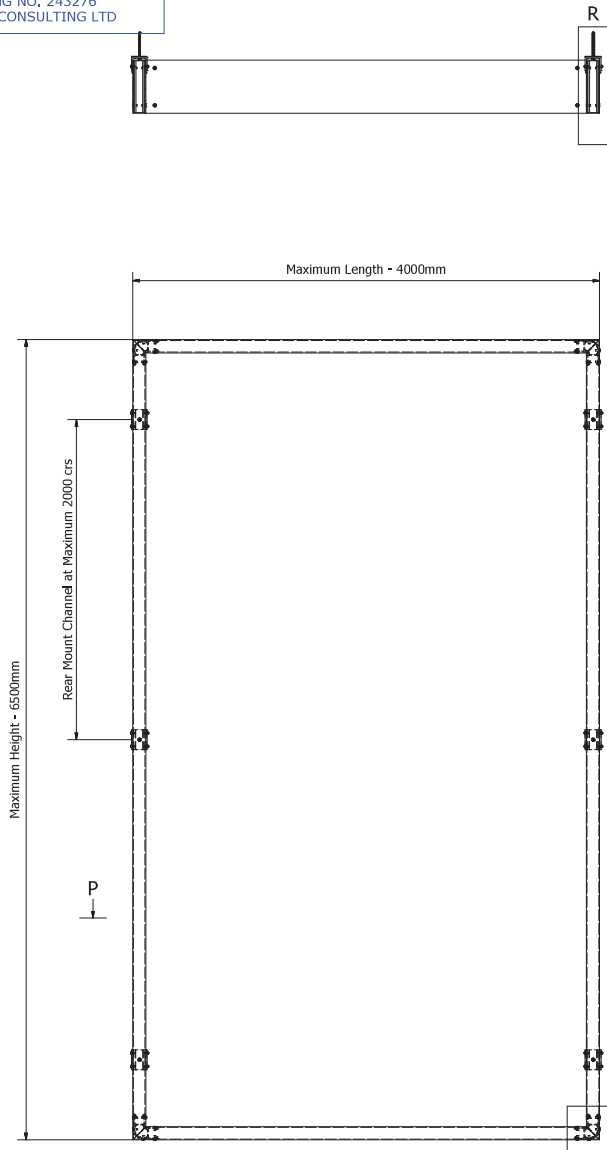

Frame Elevation 1:10

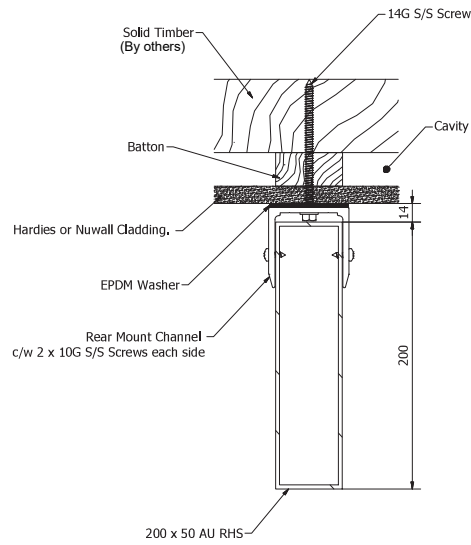

Detail C 1:2
Horizontal Fixing Detail

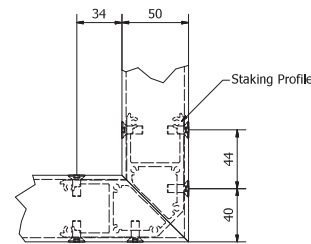

Detail B 1:2
Frame Corner Staking Detail

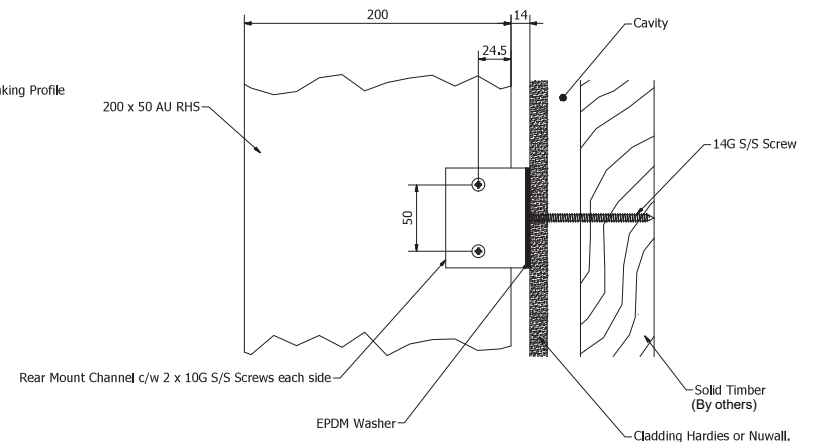

Detail D 1:2
Vertical Fixing Detail

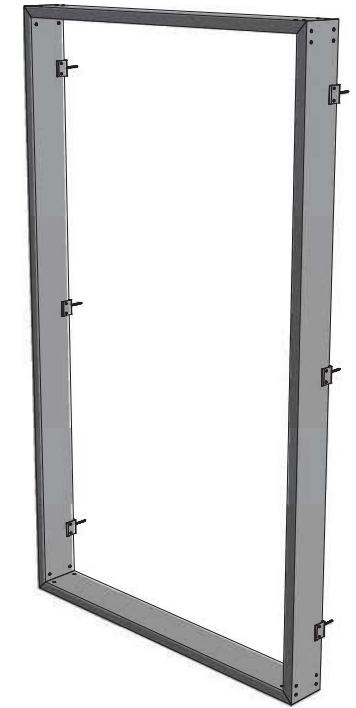

Revision Table			
Rev	Description	By	Date

Tolerance:
Dimension Decimal Places:
0 = +/- 1mm
0.0 = +/- 0.1mm
Angle = +/- 1°

*Unless otherwise stated. Do not scale. If in doubt ask.

File:
C:\Users\INSOL\Dropbox (Insol Ltd)\Insol\Product Information\Standard Details\Vendor Models\Window Hood RHS-Frame Rear Mount.Lam

Third Angle



All dimensions are in mm unless otherwise stated

Material: N/A
Weight:
Finish:
Qty Req as Shown:
Qty Req Opp Hand:

INSOL Architectural Aluminium Louvres
P O Box 231, Invercargill
Free 0800 34 6000
Ph 216 3287
Fax 03 216 5928
www.insolnz.co.nz

Title: Window Hood Standard Fixing Detail		Drawing No: IN-1 -STDWH-1.2	Rev: A
Desc: Hardies & Nu-Wall Rear Mount Channel		Org Date: 1/12/2016	App By: DM
Project No: STDWH		Scale: 1:10	

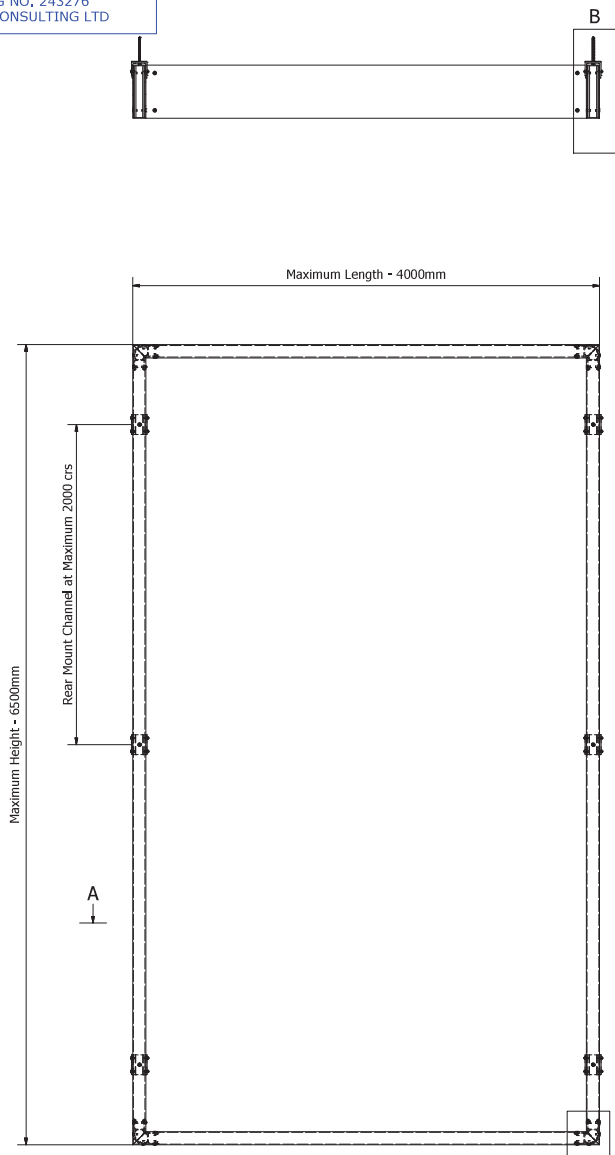

Frame Elevation 1:10

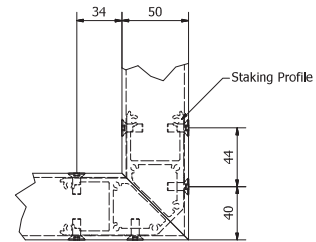
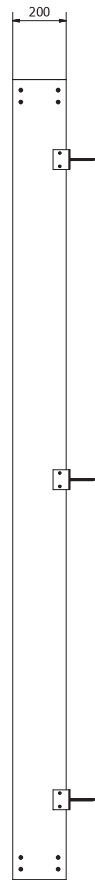

Detail B 1:2
Frame Corner Staking Detail

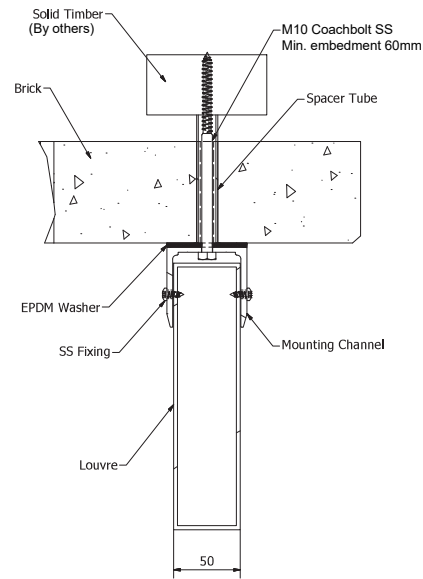

Detail C 1:2
Horizontal Fixing Detail

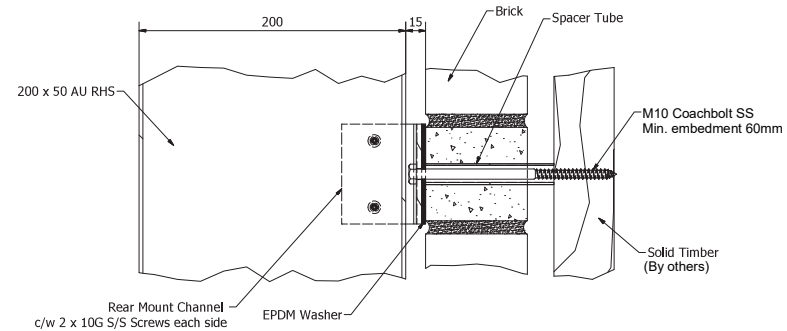

Detail D 1:2
Vertical Fixing Detail

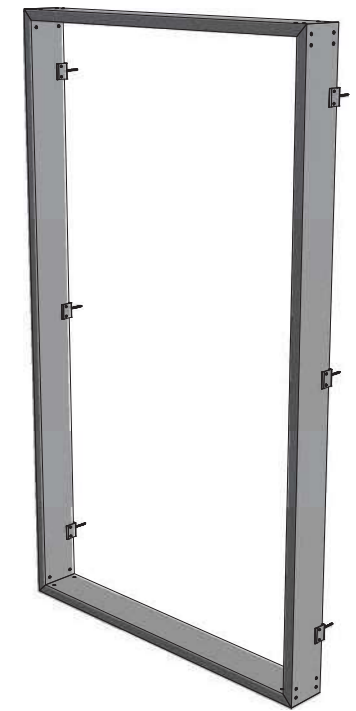

Revision Table			
Rev	Description	By	Date

Tolerance:
Dimension Decimal Places:
0 = +/- 1mm
0.0 = +/- 0.1mm
Angle = +/- 1°

*Unless otherwise stated. Do not scale. If in doubt ask.

File:
C:\Users\INSOL\Dropbox (Insol Ltd)\Insol\Product Information\Standard Details\Vendor Models\Fletcher Living Window Hood Fixing.dwg



All dimensions are in mm unless otherwise stated

Material:
Weight: 213.753 kg
Finish:
Qty Req as Shown:
Qty Req Opp Hand:

INSOL Architectural
Aluminium Louvres
P O Box 231, Invercargill
Free 0800 34 6000
Ph 216 3287
Fax 03 216 5928
www.insolnz.co.nz

Title: Window Hood Standard Fixing Detail		Drawing No: IN-1 -STDWH-1.3	Rev: A
Desc: Brick Rear Mount Channel		Org Date: 1/12/2016	App By: DM
Scale: 0.03 : 1		Project No: STDWH	A1