

AURORA™ 150F LOUVRE BLADE

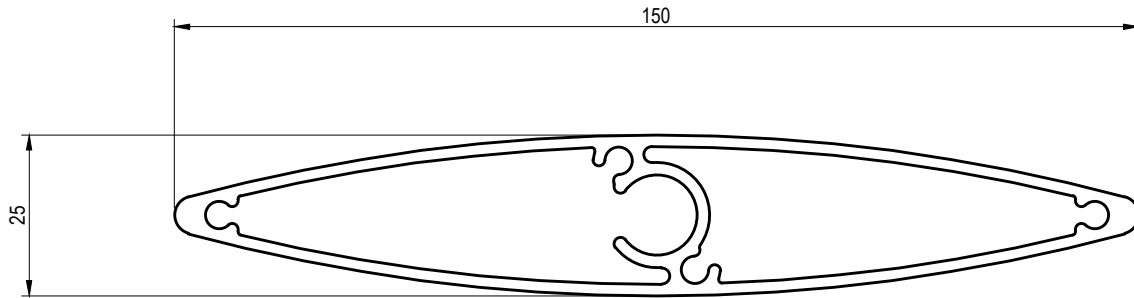

AU-LVR 150F - PROFILE

Deflections/Spans for AU-LVR 150F

Wind Zone	Self Weight	Low	Medium	High	Very High	Extra High
m/s	0.0 m/s	32 m/s	37 m/s	44 m/s	50 m/s	55 m/s
KPa	0.0 KPa	0.88 KPa	1.18 KPa	1.68 KPa	2.17 KPa	2.63 KPa
Service load kn/m	0.018	0.100	0.140	0.230	0.290	0.350
Span m	Numbers in cells are deflections in mm					
2.5	3.01	16.72	23.41	38.45	48.48	58.52
2.6	3.52	19.56	27.38	44.98	56.72	68.46
2.7	4.09	22.75	31.84	52.32	65.96	79.61
2.8	4.74	26.31	36.83	60.51	76.29	92.08
2.9	5.45	30.27	42.38	69.62	87.79	105.95
3.0	6.24	34.67	48.54	79.74	100.54	121.34
KEY:	Light Grey shading = Acceptable span		Dark Grey shading = Over recommended span		Black shading = Unsafe	

*'Over Recommended Max Span' is the point at which Aurae considers the deflection as 'unsightly'

*Deflection values assume operable louvres in the closed position (therefore no porosity factor)

*Deflection values assume simple support and do not take into account the integrity of any fixing.

*Deflection values assume a horizontal louvre (not tilted)

*Please contact Aurae if your scenario is : Above 10m height, or is in a specific design location

SHORT FORM SPECIFICATION (CONTACT INSOL FOR FULL SPECIFICATION):

LOUVRE BLADE TYPE: Louvre blades to be Insol extruded aluminium profile AU-LVR 150F, weighing 1.834 kg/lm.

FIXING METHOD: Louvre blades to be fixed / manually operable / motorised in accordance with architectural drawings and Insol technical literature.

FINISH: Louvre blades and associated support brackets to be anodised / powdercoated as specified by the Architect.

AURORA™ 150F Technical Data Sheet



© 2018 All rights reserved
Aurae Ltd
Ph: +64 9 218 8690
E: sales@aurae.co.nz
www.aurae.co.nz

Scale: N.T.S.
Date: 2/09/2015
Page: 1 of 1

AU-LVR 150F Version 1