

AURORA™ 150F LOUVRE BLADE

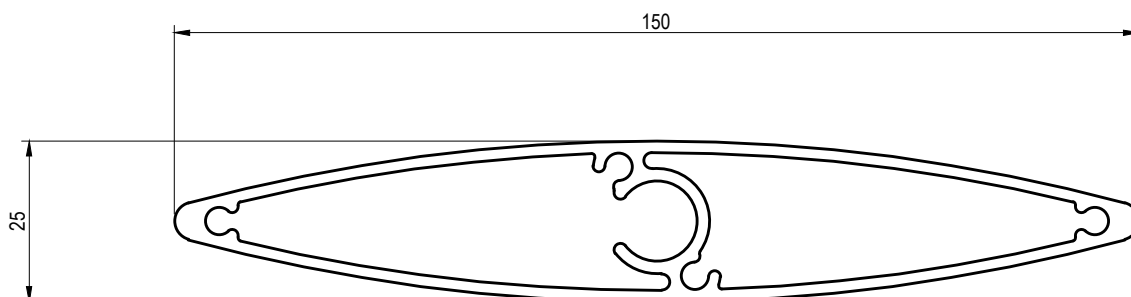

AU-LVR 150F - PROFILE

Deflections/Spans for AU-LVR 150F

| Wind Zone | Self Weight | Low | Medium | High | Very High | Extra High |
|--|--|--------------------|---|--------------------|------------------------|--------------------|
| m/s KPa | 0.0 m/s 0.0 KPa | 32 m/s 0.88 KPa | 37 m/s 1.18 KPa | 44 m/s 1.68 KPa | 50 m/s 2.17 KPa | 55 m/s 2.63 KPa |
| Service load kn/m | 0.018 | 0.100 | 0.140 | 0.230 | 0.290 | 0.350 |
| Span m | Numbers in cells are deflections in mm | | | | | |
| 2.5 | 3.01 | 16.72 | 23.41 | 38.45 | 48.48 | 58.52 |
| 2.6 | 3.52 | 19.56 | 27.38 | 44.98 | 56.72 | 68.46 |
| 2.7 | 4.09 | 22.75 | 31.84 | 52.32 | 65.96 | 79.61 |
| 2.8 | 4.74 | 26.31 | 36.83 | 60.51 | 76.29 | 92.08 |
| 2.9 | 5.45 | 30.27 | 42.38 | 69.62 | 87.79 | 105.95 |
| 3.0 | 6.24 | 34.67 | 48.54 | 79.74 | 100.54 | 121.34 |
| KEY: | Light Grey shading = Acceptable span | | Dark Grey shading = Over recommended span | | Black shading = Unsafe | |
| **Over Recommended Max Span' is the point at which Aurae considers the deflection as 'unsightly' | | | | | | |
| *Deflection values assume operable louvres in the closed position (therefore no porosity factor) | | | | | | |
| *Deflection values assume simple support and do not take into account the integrity of any fixing. | | | | | | |
| *Deflection values assume a horizontal louvre (not tilted) | | | | | | |
| *Please contact Aurae if your scenario is : Above 10m height, or is in a specific design location | | | | | | |

SHORT FORM SPECIFICATION (CONTACT INSOL FOR FULL SPECIFICATION):

LOUVRE BLADE TYPE: Louvre blades to be Insol extruded aluminium profile AU-LVR 150F, weighing 1.834 kg/lm.

FIXING METHOD: Louvre blades to be fixed / manually operable / motorised in accordance with architectural drawings and Insol technical literature.

FINISH: Louvre blades and associated support brackets to be anodised / powdercoated as specified by the Architect.

AURORA™ 150F Technical Data Sheet



© 2018 All rights reserved
Aurae Ltd
Ph: +64 9 218 8690
E: sales@aurae.co.nz
www.aurae.co.nz

Scale: N.T.S.
Date: 2/09/2015
Page: 1 of 1

AU-LVR 150F Version 1